

# Post Consultation Masterplan

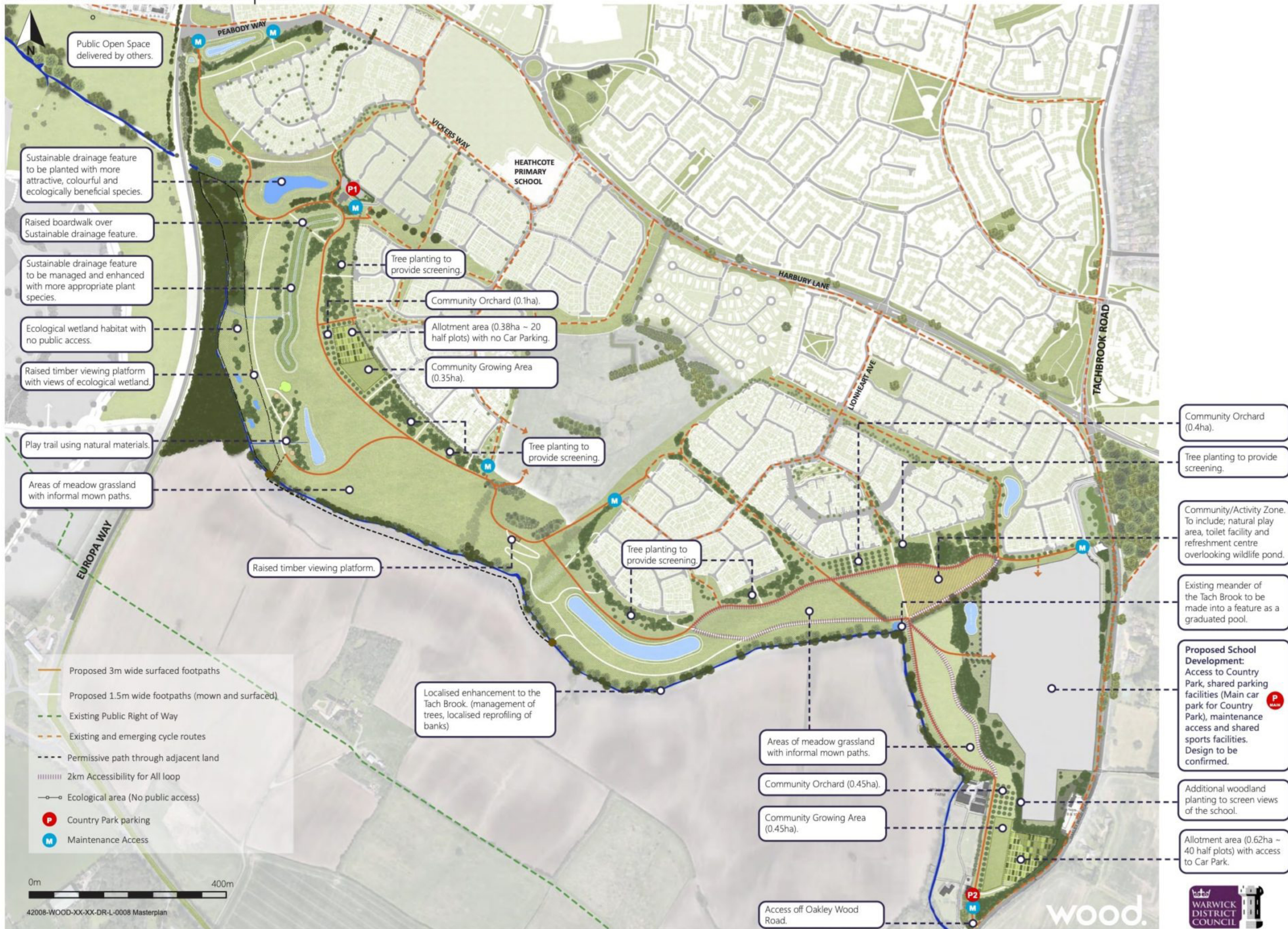

- Proposed 3m wide surfaced footpaths
- Proposed 1.5m wide footpaths (mown and surfaced)
- - - Existing Public Right of Way
- - - Existing and emerging cycle routes
- - - Permissive path through adjacent land
- ||||| 2km Accessibility for All loop
- Ecological area (No public access)
- P** Country Park parking
- M** Maintenance Access

- Community Orchard (0.4ha).
- Tree planting to provide screening.
- Community/Activity Zone. To include; natural play area, toilet facility and refreshment centre overlooking wildlife pond.
- Existing meander of the Tach Brook to be made into a feature as a graduated pool.
- Proposed School Development: Access to Country Park, shared parking facilities (Main car park for Country Park), maintenance access and shared sports facilities. Design to be confirmed.
- Additional woodland planting to screen views of the school.
- Allotment area (0.62ha ~ 40 half plots) with access to Car Park.